

BUILDING 1 | WEST SIDE OF SH-130

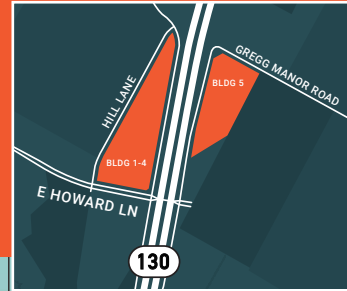

BUILDING 1 SPECS

Timing	Breaking Ground 2024
Total Size	98,895 SF
Building Type	Rear Load
Column Spacing	52' x 60' Typical with 60' Speed Bay
Clear Height	32'
Ramps	2
Deck Doors	(32) 9'x10' OVHD Doors (2) 12'x14' OVHD Doors w/ Ramps
Building Size	180' x 550'
Truck Court Depth	120'
Sprinklers	ESFR
Power	2,000 Amps
Auto Parking	154 Spaces

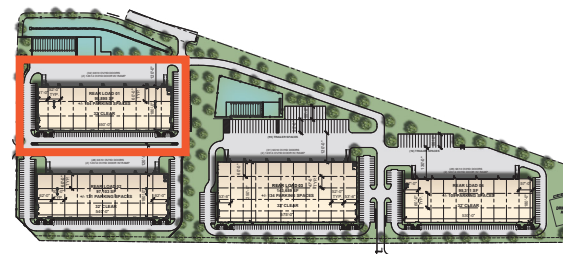
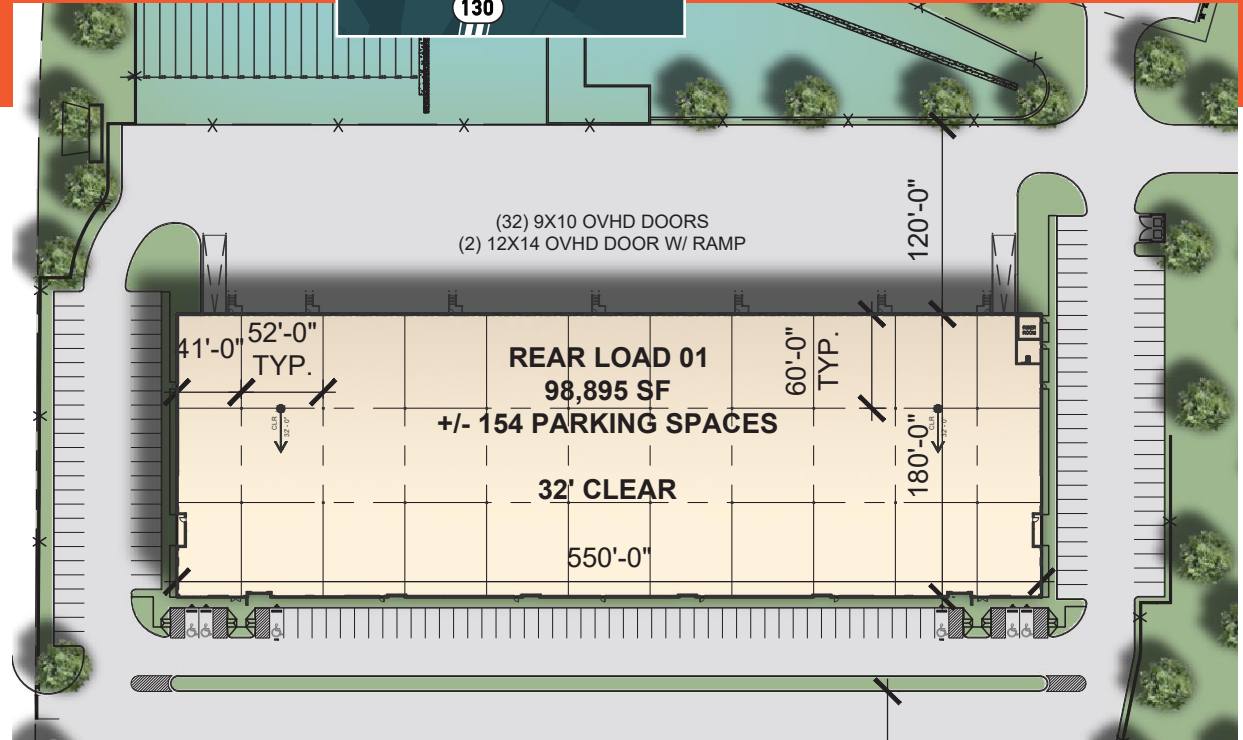

BUILDING 1 TOTAL SIZE: 98,895 SF

BUILDING 2 | WEST SIDE OF SH-130

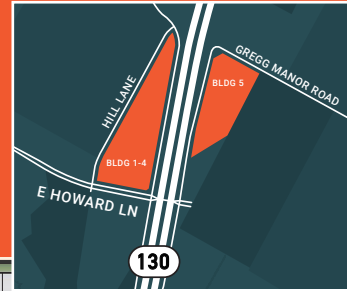

BUILDING 2 SPECS

Timing	Breaking Ground 2024
Total Size	97,103 SF
Building Type	Rear Load
Column Spacing	52' x 60' Typical with 60' Speed Bay
Clear Height	32'
Ramps	2
Deck Doors	(28) 9'x10' OVHD Doors (2) 12'x14' OVHD Doors w/ Ramps
Building Size	180' x 540'
Truck Court Depth	120'
Sprinklers	ESFR
Power	2,000 Amps
Auto Parking	131 Spaces

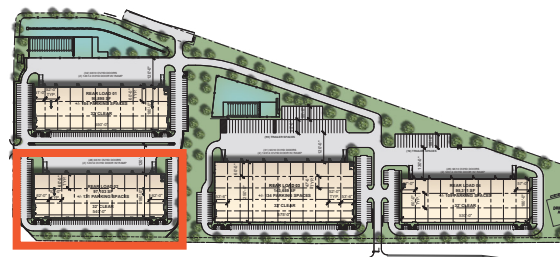
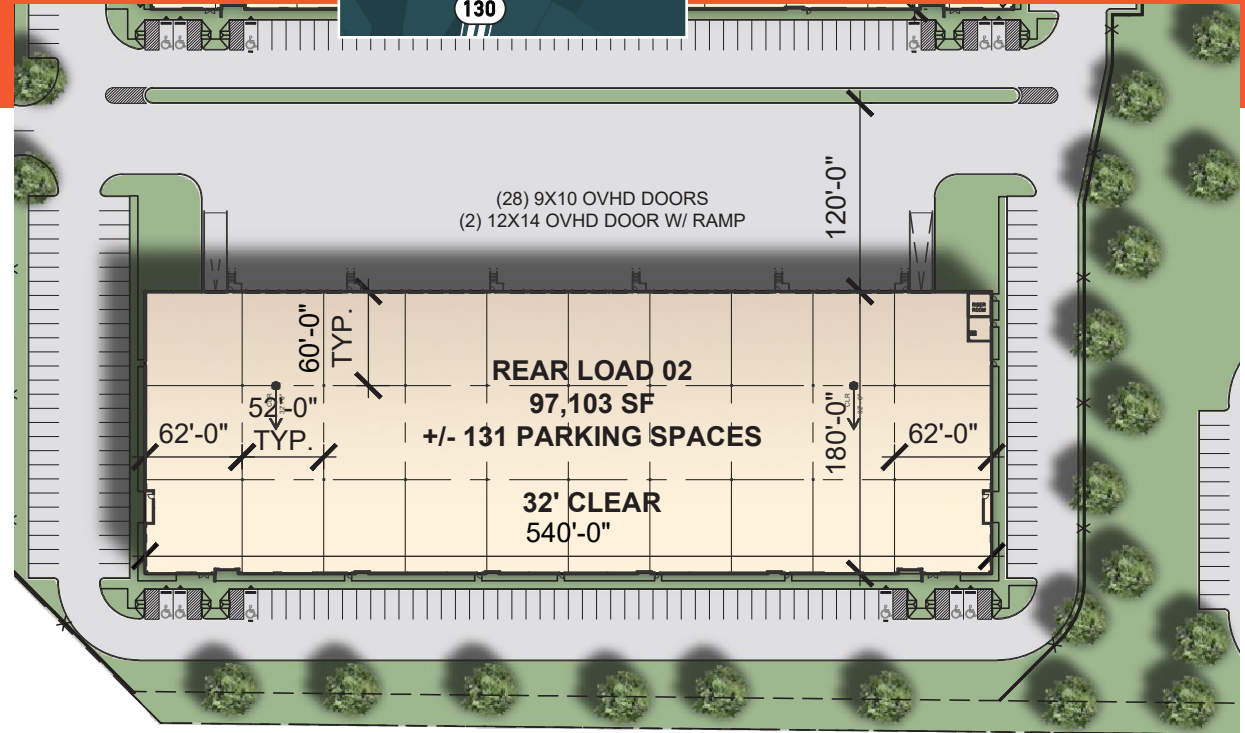

BUILDING 2 TOTAL SIZE: 97,103 SF

BUILDING 3

WEST SIDE OF SH-130

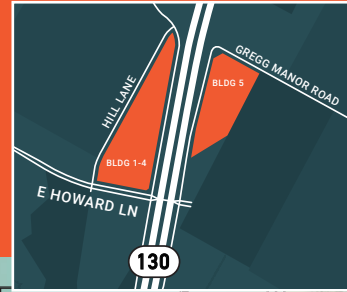

BUILDING 3 SPECS

Timing	Breaking Ground 2024
Total Size	143,659 SF
Building Type	Rear Load
Column Spacing	52' x 60' Typical with 60' Speed Bay
Clear Height	32'
Ramps	2
Deck Doors	(31) 9'x10' OHD Doors (2) 12'x14' OHD Doors w/ Ramps
Building Size	250' x 575'
Truck Court Depth	120'
Sprinklers	ESFR
Power	2,000 Amps
Auto Parking	134 Spaces
Trailer Parking	55 Spaces



BUILDING 3 TOTAL SIZE: 143,659 SF

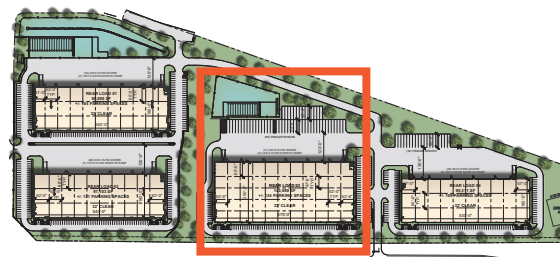

BUILDING 4 | WEST SIDE OF SH-130

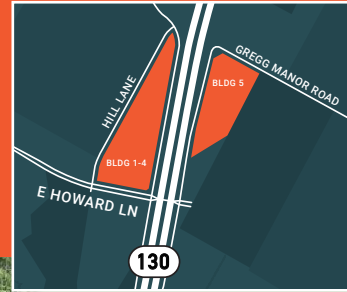

BUILDING 4 SPECS

Timing	Breaking Ground 2024
Total Size	95,311 SF
Building Type	Rear Load
Column Spacing	52' x 60' Typical with 60' Speed Bay
Clear Height	32'
Ramps	2
Deck Doors	(26) 9'x10' OHD Doors (2) 12'x14' OHD Doors w/ Ramps
Building Size	160' x 400'
Truck Court Depth	125'
Sprinklers	ESFR
Power	2,000 Amps
Auto Parking	109 Spaces
Trailer Parking	19 Spaces

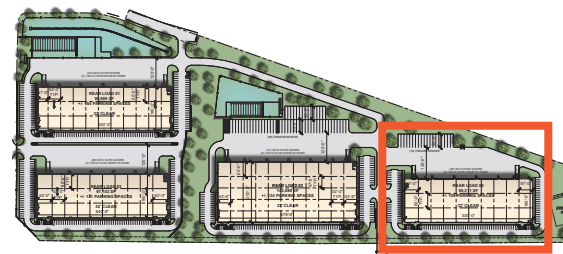
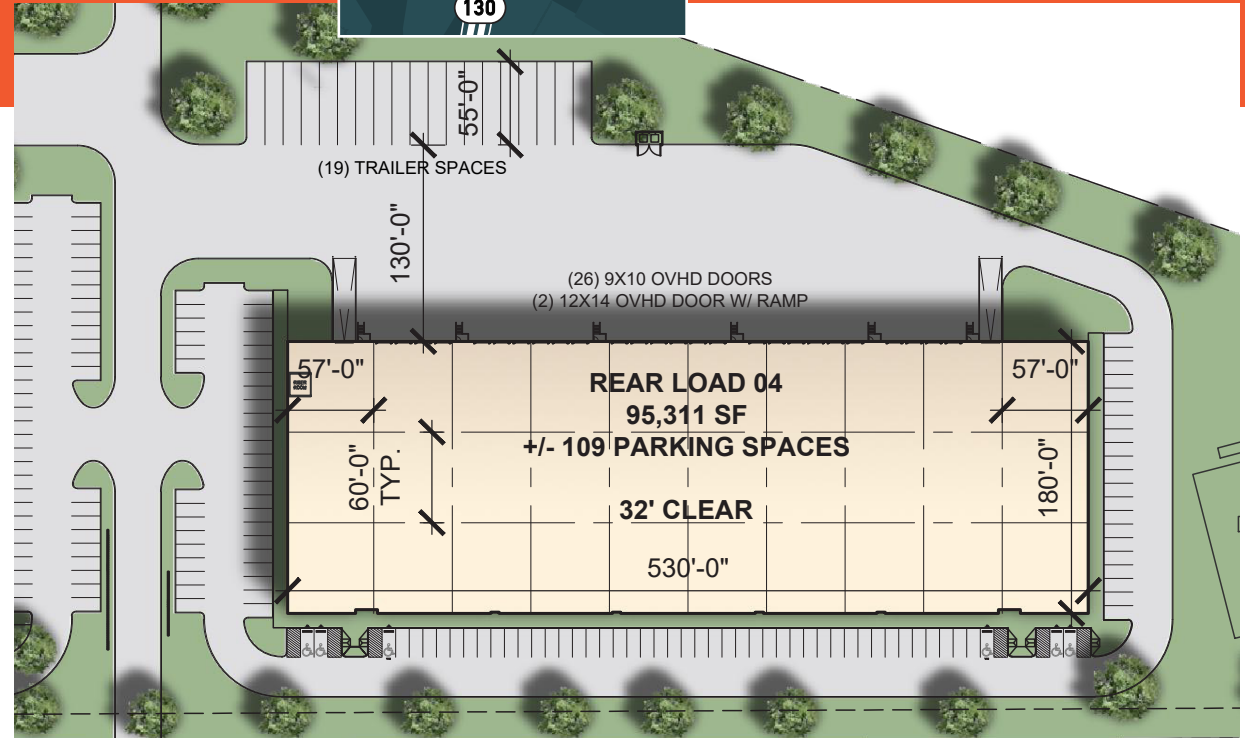

BUILDING 4 TOTAL SIZE: 95,311 SF

BUILDING 5 | EAST SIDE OF SH-130

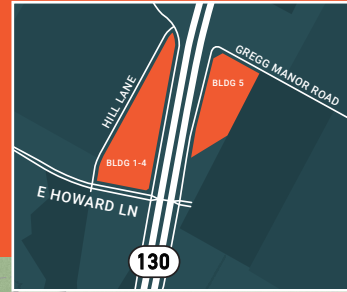

BUILDING 5 SPECS

Timing	Breaking Ground 2024
Total Size	281,010 SF
Building Type	Cross Dock
Column Spacing	56' x 60" Typical with 60' Speed Bay
Clear Height	36'
Ramps	4
Deck Doors	(87) 9'x10' OHD Doors (4) 12'x14' OHD Doors w/ Ramps
Building Size	300' x 894'
Truck Court Depth	130'
Sprinklers	ESFR
Power	2,000 Amps
Auto Parking	202 Spaces
Trailer Parking	79 Trailer Spaces 35 Box Truck Spaces

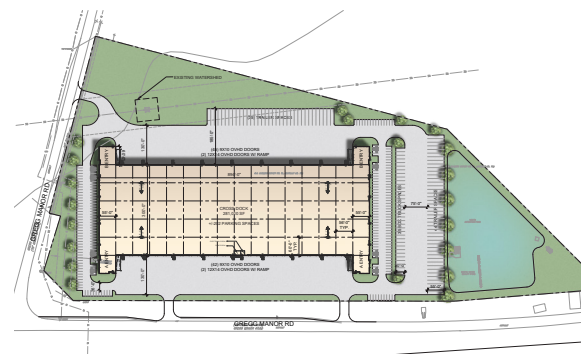
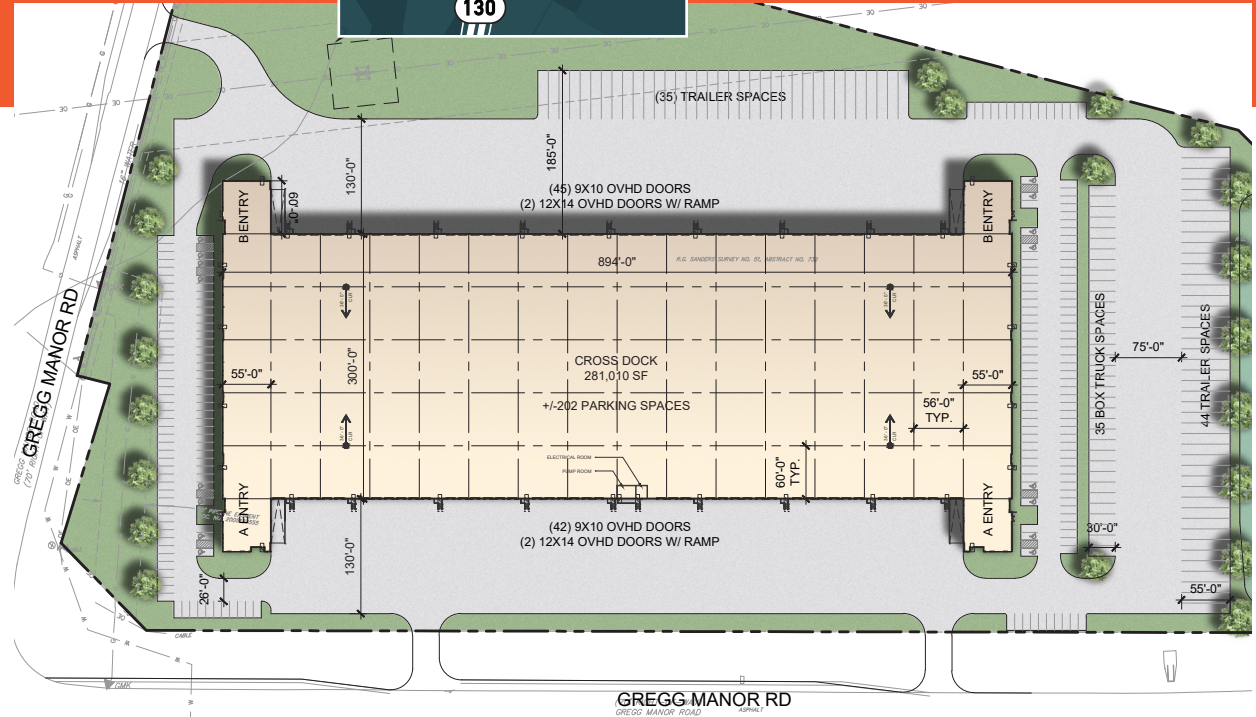

BUILDING 5 TOTAL SIZE: 281,010 SF